

CIF Center Tube Kits



Unlock Sustainable Filtration

The CIF Center Tube Kit provides everything needed for a simple, one-time conversion of your existing 6" microfilter elements to coreless, metal-free CIF and FA-CIF Series filters.

Key Features

- **Easy Conversion:** Complete hardware package for quick retrofit of standard 6" (152 mm) OD filters
- **One-Time Installation:** Single retrofit enables ongoing use of sustainable CIF and FA-CIF Series elements
- **Immediate Impact:** Start reducing filter disposal volume by up to 80% with your next cartridge change
- Isoplast Engineered Thermoplastic provides aviation-grade strength at a fraction of the weight of metal

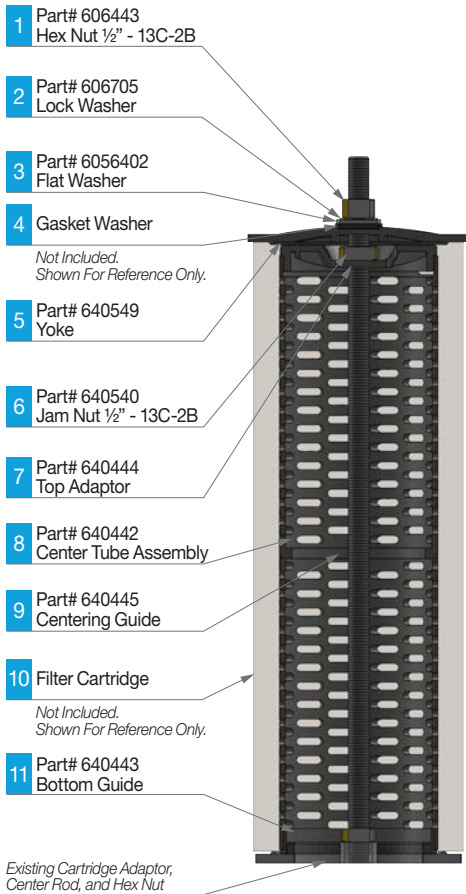

Parts for Assembly

Item	Quantity			
	CIF1KIT for 14 1/2" Cartridge	CIF2KIT for 28 3/4" Cartridge	CIF3KIT for 43 1/4" Cartridge	CIF4KIT for 56" Cartridge
1	1	1	1	1
2	1	1	1	1
3	1	1	1	1
4	*	*	*	*
5	1	1	1	1
6	1	1	1	1
7	1	1	1	1
8	1	2	3	4
9	0	1	2	3
10	*	*	*	*
11	1	1	1	1

Installation Instructions:

Step 1: Install the CIF Center Tube (One-Time Setup)

1. Remove the existing filter cartridge. Leave center rod in place.
2. Thoroughly clean the bottom and sides of the vessel of any particulate or biological contamination.
3. Identify the bottom of the center tube. Only the top accepts the top adaptor (7).
4. Place center tube assembly (8) with the bottom guide (11) down, aligning it on the existing cartridge adaptor.
5. For kit numbers CIF2 and CIF3 only: Align centering guide (9) over the center rod.
6. Slide top adaptor (7) over center rod and secure with jam nut (6). Tighten to 5 ft-lbs (6.78 Nm). Your semi-permanent center tube is now installed.

Step 2: Install the CIF Cartridge (Each Changeout)

1. Slide cartridge (10) over center tube. Install new black yoke (5) with domed head facing up.
2. Place rubber gasket washer (4) over center rod.
3. Add flat steel washer (3), then steel lock washer (2).
4. Secure with hex nut (1) and tighten to 5 ft-lbs (6.78 Nm).

